

PRESA DI FORZA A COMANDO PNEUMATICO

PNEUMATIC CLUTCH POWER TAKE-OFF

CODICE PTO
PTO CODE

60-75-00148

CAMBIO
GEARBOX

DONGFENG



DIAGRAMMA DI UTILIZZO WORKING CONDITION

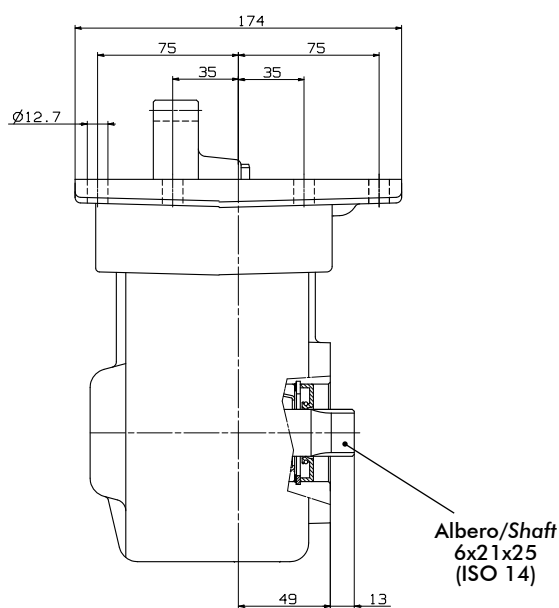
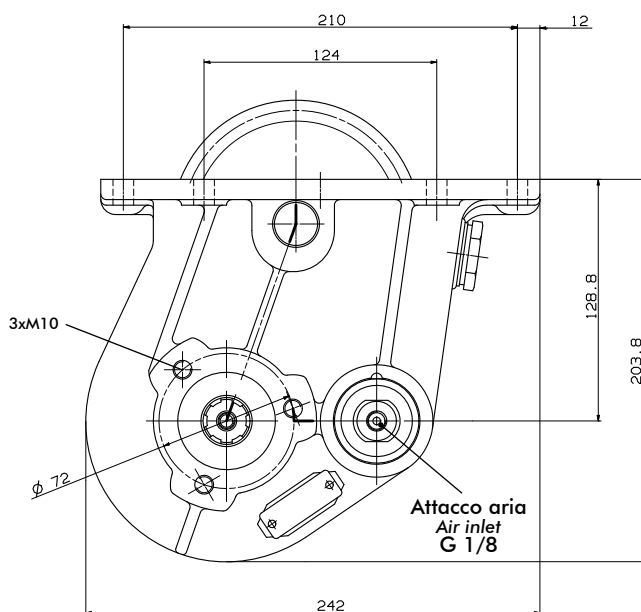
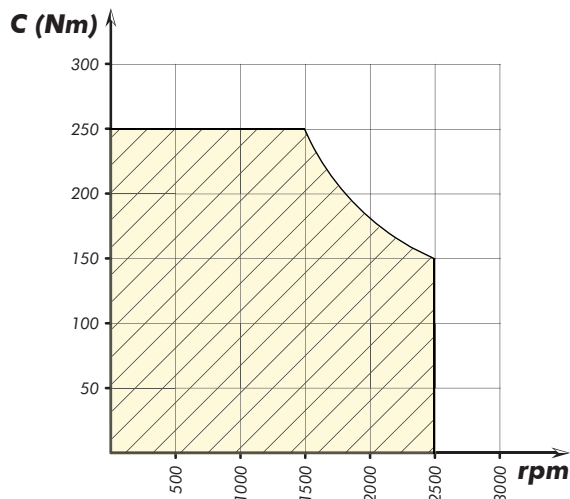

Data: Martedì 07 agosto 2012

Codice foglio: 997-260-07513 Rev: //

Tipo cambio Gearbox	Codice PTO PTO code	Versione Version	Giri pto a 1000 giri motore Pto ratio@1000 eng.rpm rpm	Coppia massima Max torque Nm	Lato montaggio Mounting side	Uscita Output	Rotazione Rotation	Kit di montaggio Mounting kit	Peso Weight Kg
DF6S 900/7.95	60-75-148	13	900	250	Later. sx. Left side	Anter. Front	Antior. Acw.	154-3-4865	14,5

pag.1