

**PRESA DI FORZA A  
COMANDO PNEUMATICO  
"POWERFUL EVO"  
PNEUMATIC CLUTCH  
POWER TAKE-OFF  
"POWERFUL EVO"**

**CODICE PTO**  
PTO CODE

**01007120170**

**CAMBIO**  
GEARBOX

**EATON - VOLVO  
MERCEDES - ZF**

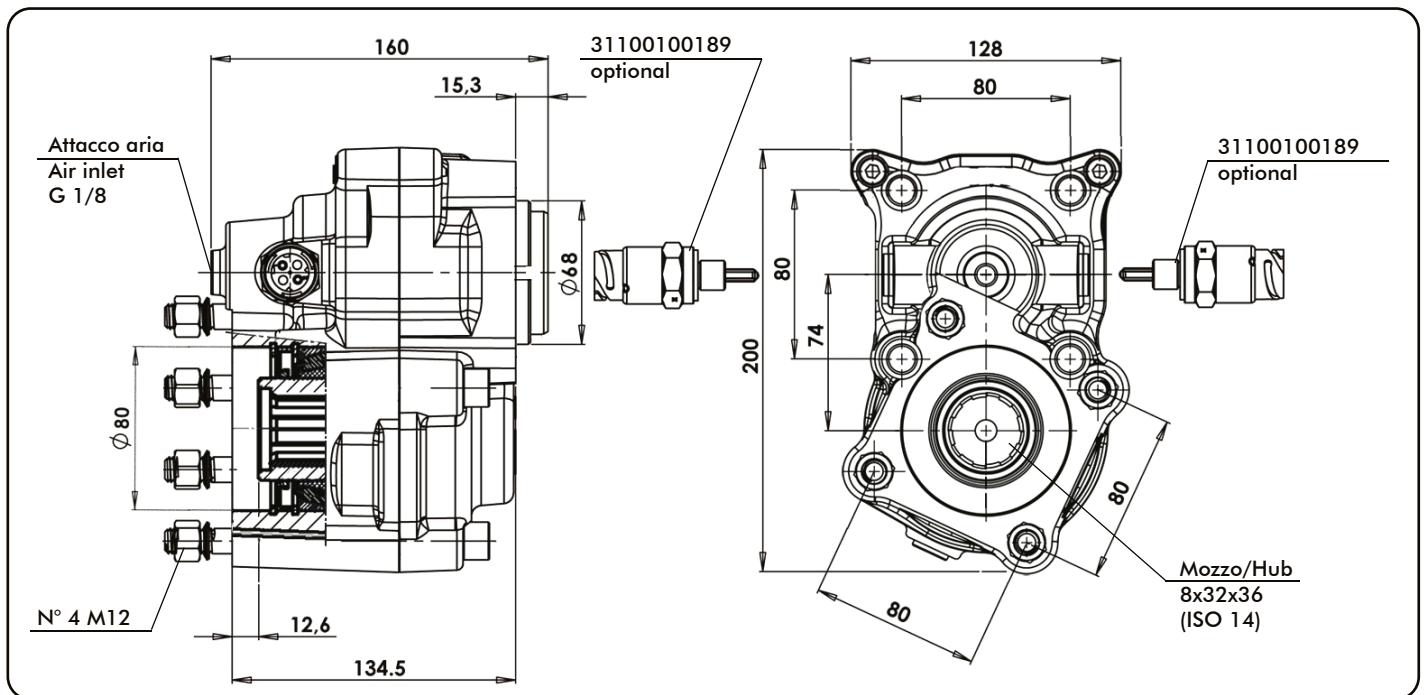
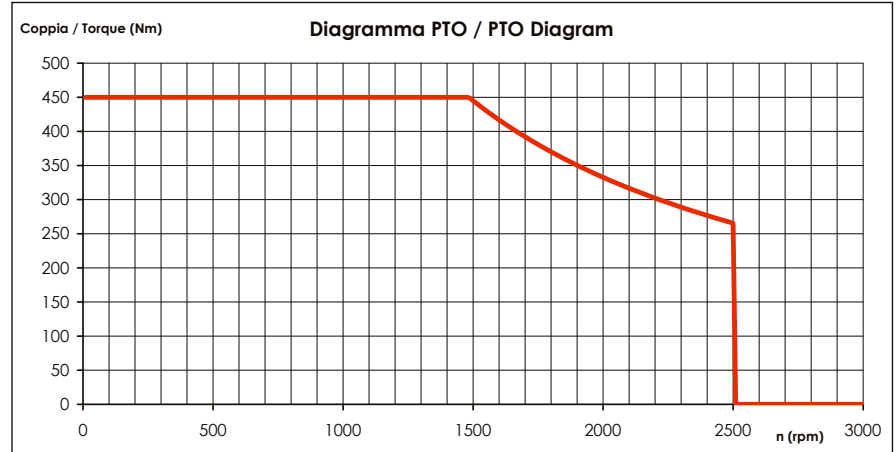
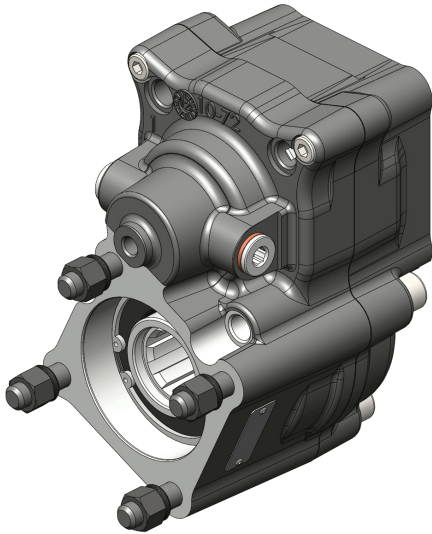

01/02/2021

Rev: AA

99721027117

Codice PTO PTO code	Versione Version	Rapporto interno Internal ratio	Giri pto a 1000 giri motore Pto ratio@1000 eng.rpm rpm	Coppia massima Max torque Nm	Lato montaggio Mounting side	Uscita Output	Rotazione Rotation	Kit di montaggio Mounting kit	Peso Weight Kg
<b>01007120170</b>	17	1:1,75	Vedi indice See index	<b>450</b>	Poster. Rear	Poster. Rear	Ant. Acw	Vedi indice See index	<b>8,7</b>

pag.1



O.M.F.B. S.p.A. Hydraulic Components  
We reserve the right to make any changes without notice.  
Edition 2014.09 No reproduction, however partial, is permitted.  
Via Cave, 7/9 25050 Provaglio d'Iseo (Brescia) Italy Tel.: +39.030.9830611  
Fax: +39.030.9839207-208 Internet:www.omfb.it e-mail:info@omfb.it

**COMPANY WITH  
QUALITY SYSTEM  
CERTIFIED BY DNV GL  
= ISO 9001:2015 =**